

# CAPITOL VIEW ELEMENTARY - DROP OFF LANE CONCEPT PLAN

**Features:**

- Existing drive extend as far west as possible, before meeting required separation from E 15th St.
- Inset pick-up lane for 5 buses.
- Leaves fire hydrant alone, without relocating it behind walk on school property.

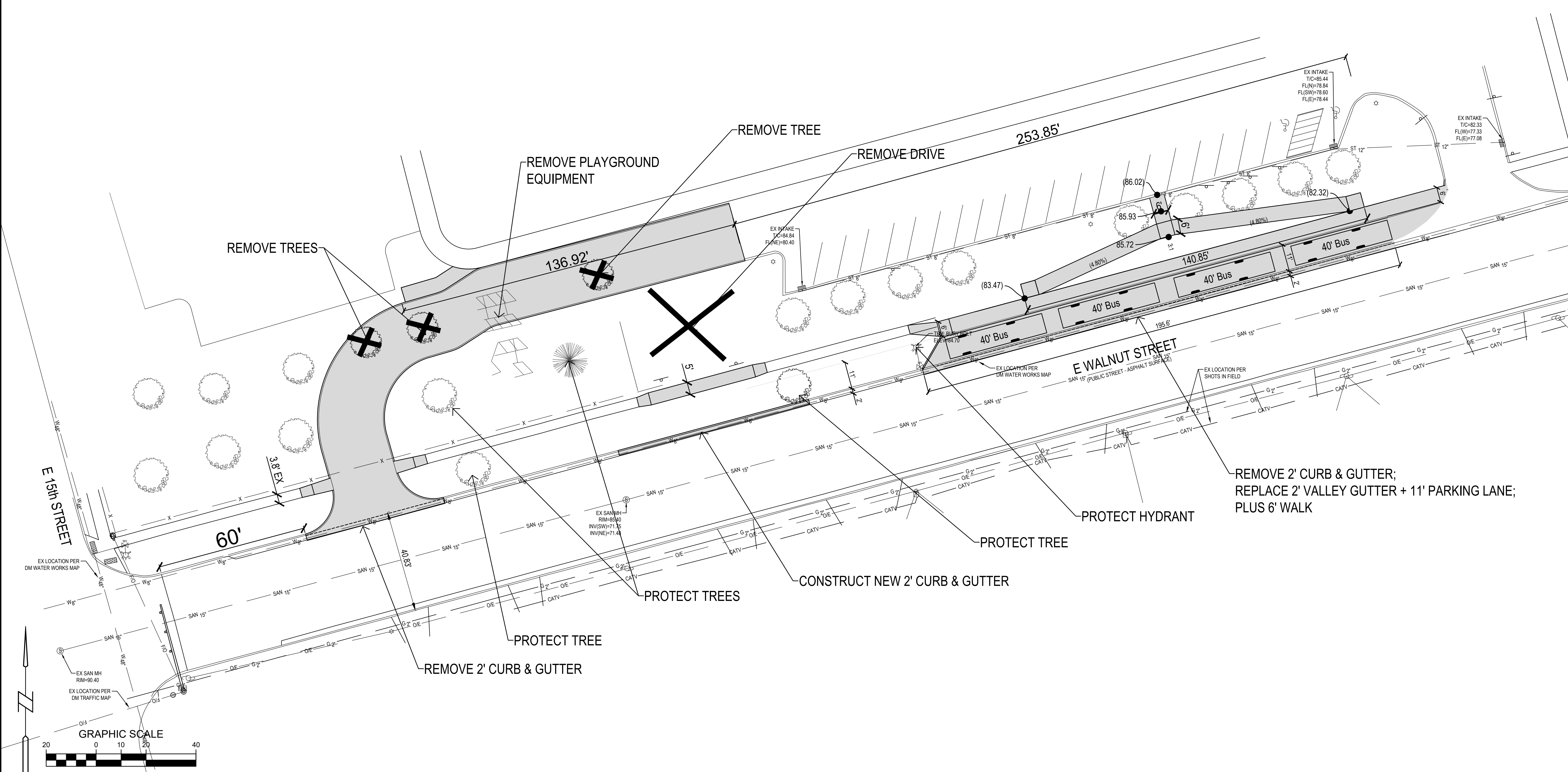

**CAPITOL VIEW ELEMENTARY - DROP OFF LANE**  
1535 CAPITOL AVE. DES MOINES IOWA

**Bishop Engineering**  
"Planning Your Successful Development"  
3501 104th Street  
Des Moines, Iowa 50322-3825  
Phone: (515)276-0467 Fax: (515)276-0217  
Civil Engineering & Land Surveying  
Established 1959

REFERENCE NUMBER:
DRAWN BY: CEJ
CHECKED BY: RHB
REVISION DATE:
PROJECT NUMBER: 200356
SHEET NUMBER: 1 OF 1