

PRELIMINARY- NOT FOR CONSTRUCTION

GENERAL NOTES:
1. XXXXXX
2. XXXXXX
3. XXXXXX

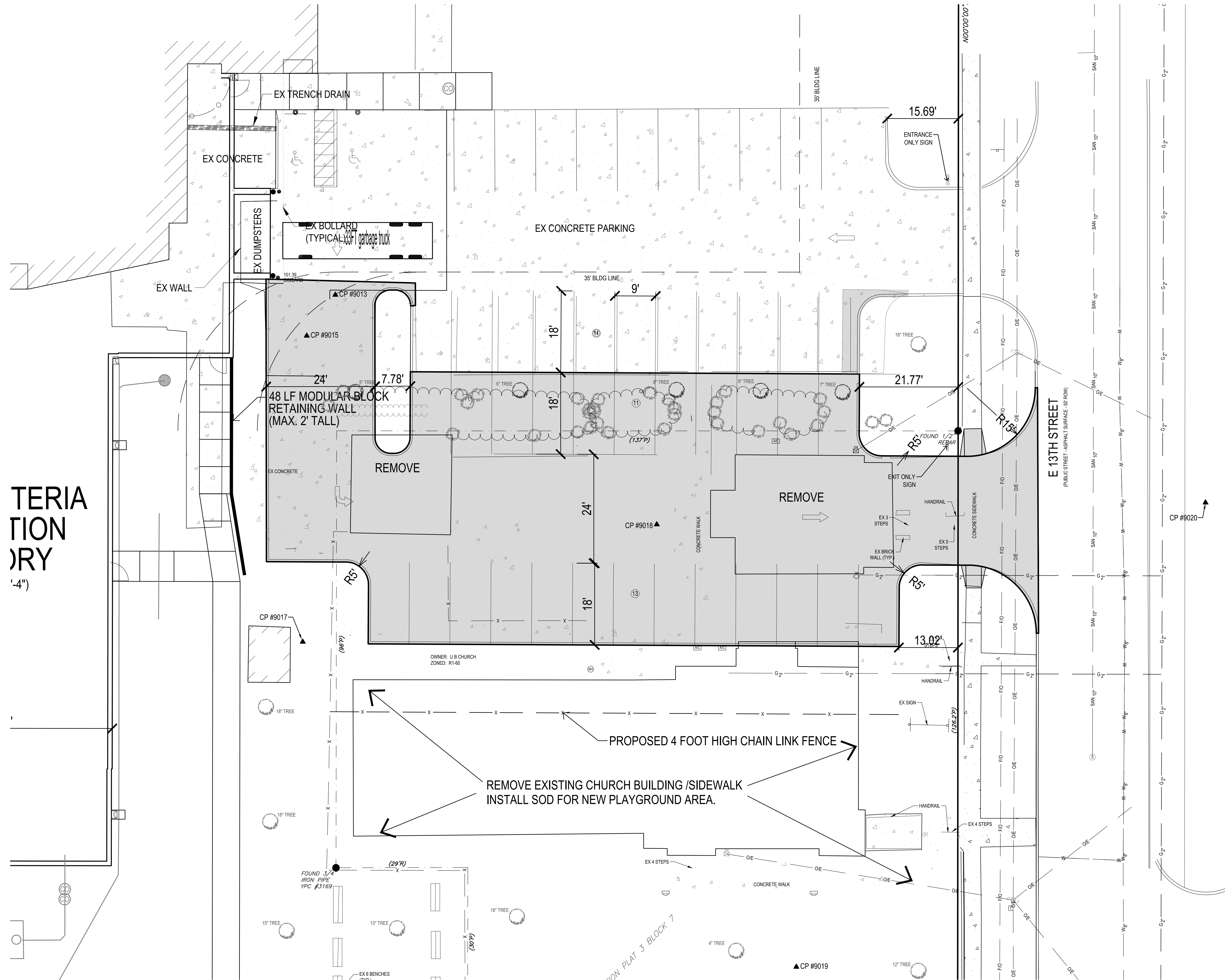

TERIA
TION
RY
'-4")

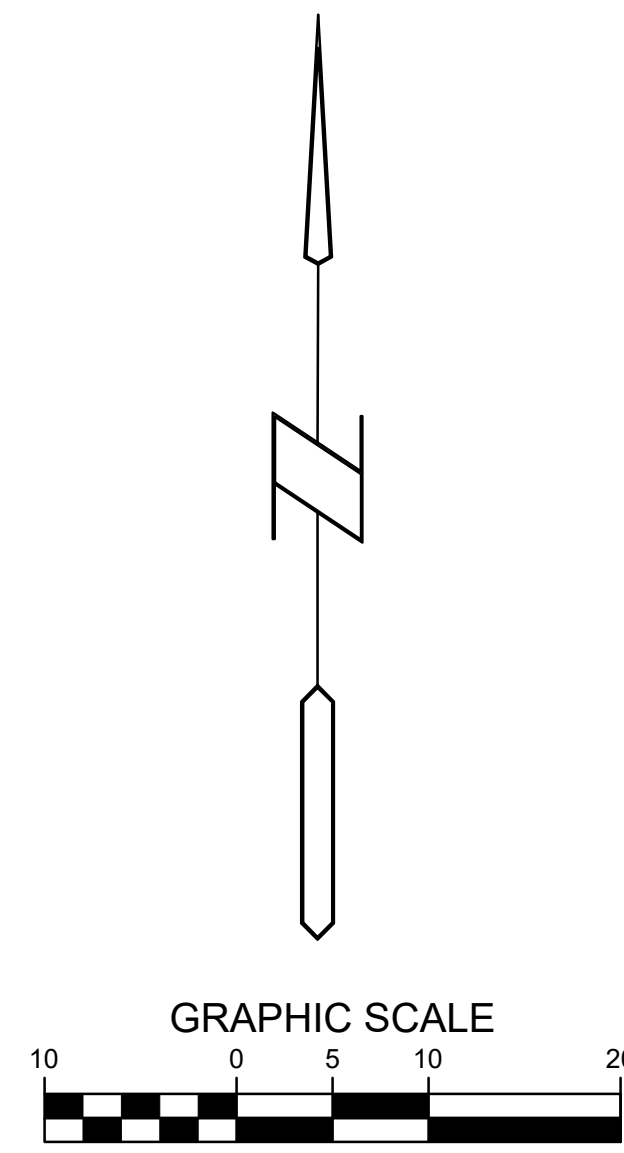

10/26/2018 2:42:07 PM M:\LAND PROJECTS 2018\180342 CATTLELL ELEMENTARY\DWG\C2 LAYOUT.DWG



CATTLELL ELEMENTARY SCHOOL
3101 E 12th STREET, DES MOINES, IA, 50316

LAYOUT PLAN

REFERENCE NUMBER: 150102 160304
DRAWN BY:
CHECKED BY:
REVISION DATE:
PROJECT NUMBER: 180342
SHEET NUMBER: C2.1

Des Moines, Iowa 50322-3825
Phone: (515)276-0467 Fax: (515)276-0217
Civil Engineering & Land Surveying Established 1959